

琉球大学学術リポジトリ

米国管理下の南西諸島状況雑件 沖縄関係 軍用地問題（収用、賃貸、解除保証） 3

| | |
|-------|---|
| メタデータ | 言語: 出版者: 公開日: 2019-02-07 キーワード (Ja): キーワード (En): 作成者: - メールアドレス: 所属: |
| URL | http://hdl.handle.net/20.500.12000/43640 |

スナインジャー
45/13/17



EMBASSY OF THE
UNITED STATES OF AMERICA

Tokyo, Japan

March 17, 1970

多信
長
手
紙
三

Mr. Fumihiko Togo
Director-General
American Affairs Bureau
Ministry of Foreign Affairs
Tokyo

Dear Mr. Togo:

Enclosed herewith are descriptions of four sets of properties presently used by the U.S. Government in Okinawa, which the United States probably will dispose of prior to June 30, 1970. The properties concerned are the following:

1. Approximately 51.98 Acre Portion of Kadena Site No. 1
2. Approximately 15.18 Acre Portion of Kadena Site No. 2
3. Approximately 19.96 Acre Portion of Kadena Site No. 4
4. Approximately 6.62 Acre Portion of Yoza Dake Air Station

Sincerely yours

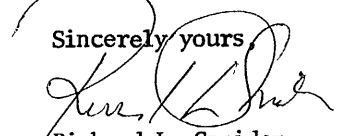
Richard L. Sneider
Deputy Chief of Mission

Enclosures:

As stated.

Proposed Release of Kadena Site No. 1 (Mace-B)

Attached as inclosure 1 is a multiplex map overlay, scale 1:14,400. Indicated by line thereon is the boundary of subject installation which is located entirely within the boundary of the Army installation known as Bolo Trainfire Range in the municipality of Yomitan Son. Kadena Site No. 1 is listed in USBRO and occupies 51.98 acres of land at a total annual rent of \$12,812.17 payable starting 1 July 1970. An indefinite leasehold interest in the 51.98 acres of land is held by the U. S. Government under the terms of the documents listed below.

| <u>Leasehold Document No.</u> | <u>Acres Leased</u> | <u>Annual Rent</u> |
|----------------------------------|---------------------|---------------------|
| Master Lease No. DA92328-ENG-225 | 11.01 | \$ 3,099.79 |
| " " " DA92328-ENG-258 | 39.72 | 9,412.94 |
| " " " DA92328-ENG-419 | .70 | 176.47 |
| Declaration of Taking No. 274 | .55 | 122.97 |
| TOTAL: | <u>51.98</u> | <u>\$ 12,812.17</u> |

Approximately 20 acres of the leased land outside the security fence for the installation are granted for farming purposes under license No. DACA79-3-69-32 issued to the Municipality of Yomitan Son. This license will expire on 31 March 1974.

No encroaching structures exist within the leased land comprising subject installation including access road and water line thereto. Unauthorized cultivation of sugar cane is being conducted within the sighting zone.

Attached as inclosure 2 is a list of existing buildings and facilities associated thereto within subject installation. Hqs 824th Combat Support Group has advised that the buildings and facilities thereto will be transferred, with the underlying land, on a nonreimbursable basis, to any other interested military service or agency. If the land is to be released to the owners, the Air Force will remove serviceable items worthy of salvage from the buildings.

Upon our receipt of authority to release the land if no Military Service or Federal Agency has a requirement therefor, Notices of Termination will be filed with the Government of the Ryukyu Islands on or before 1 May 1970 to effect release as of 30 June 1970. To avoid payment for a full year's rent for FY-71, Notices of Termination must be filed on or before 30 June 1970. Release of the land will permit unrestricted use by the owners and the U.S. Government will accrue benefits from reduced land rental payments. Rights-of-way for U.S. Forces utility lines and access roads, if any, traversing the area to be released will be retained.

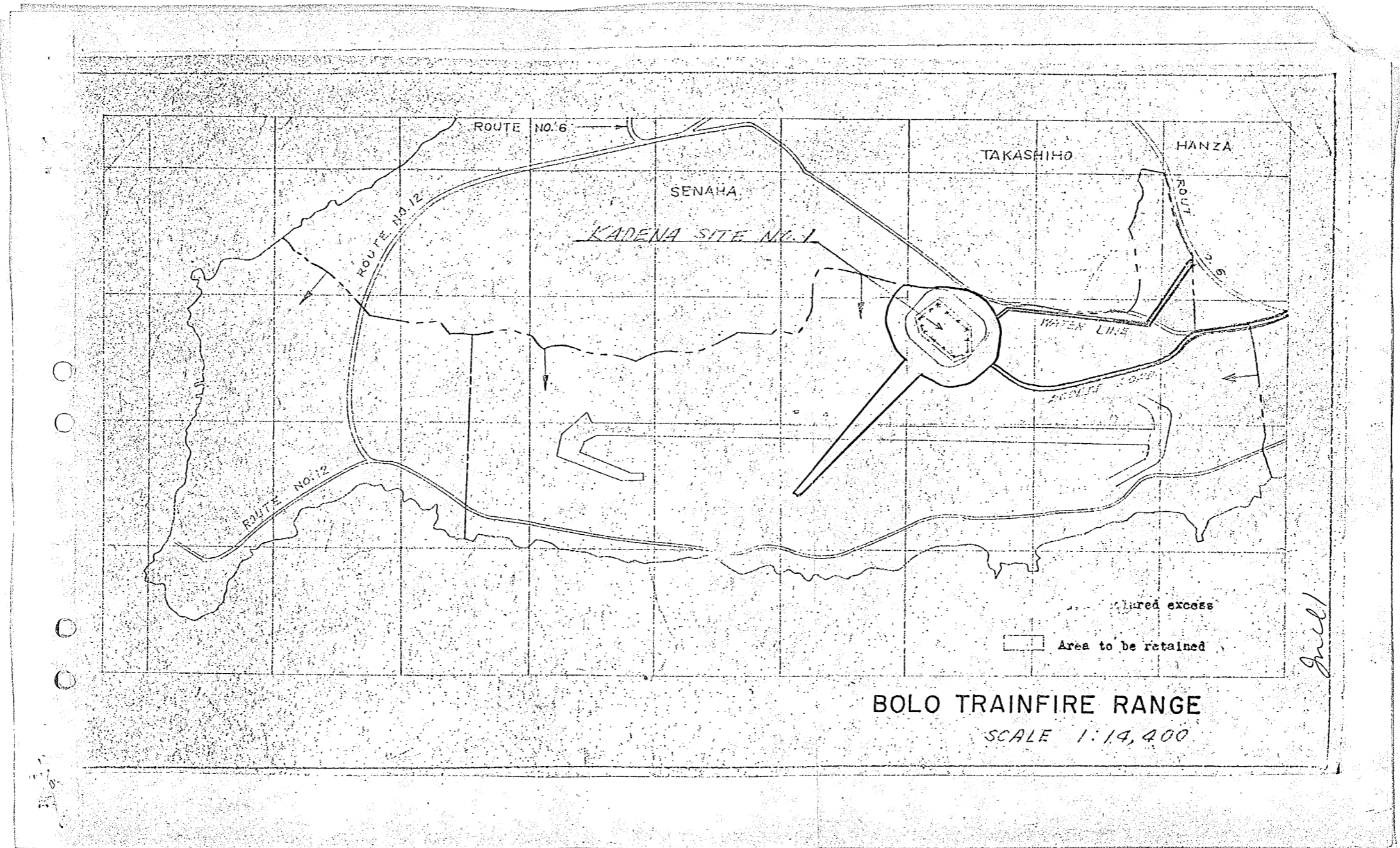

KADENA SITE NR 1

| <u>BUILD #</u> | <u>CAF CODE</u> | <u>NOMENCLATURE</u> | <u>TYPE OF BLDG</u> | <u>DIMENSIONS</u> | <u>SQ FT</u> | <u>OCCUPANT</u> | <u>GRID #</u> | <u>COST CODE</u> |
|----------------|-----------------|------------------------|---------------------|-------------------|--------------|-----------------|------------------|------------------|
| 1 | 730-832 | SP Con Ident | Conc Blk | 11x17 | 187 | 498th-TMG | Kadena Site Nr 1 | 57301 |
| 2 | 841-165 | Water, Supply Treatmt | Conc Blk | 12x14 | 168 | 498th-TMG | Kadena Site Nr 1 | 58410 |
| 3 | 141-175 | G/M Launch Control | Reinf Conc | 34x233 | 7,922 | 498th-TMG | Kadena Site Nr 1 | 51411 |
| 4 | 149-811 | Tunnel | Reinf Conc | 426 FT (Length) | | 498th-TMG | Kadena Site Nr 1 | 51505 |
| 5 | 149-512 | Missile Launch Fac | Reinf Conc | EA 8 | | 498th-TMG | Kadena Site Nr 1 | 51505 |
| 6 | 442-628 | Shed, Sup & Equip Base | Conc Blk | 4x6 | 24 | 498th-TMG | Kadena Site Nr 1 | 54401 |
| 7 | 442-257 | Stor Paint & Dope Bse | Conc Blk | 15x15 | 225 | 498th-TMG | Kadena Site Nr 1 | 54401 |
| 8 | 872-845 | Security Guard Tower | Conc Blk | 11x11 | 121 | 498th-TMG | Kadena Site Nr 1 | 58724 |

LXFN

incl 2

KADENA SITE NR 1 - BASIC DATA

| <u>DESCRIPTION</u> | <u>CATEGORY ITEM NR</u> | <u>UNIT</u> | <u>QUANTITY</u> | <u>CODE</u> | <u>OTHER QUANTITY</u> | <u>OTHER UNIT</u> | <u>PERM</u> | <u>TEMP</u> | <u>SEMI PERM</u> |
|---|-----------------------------|-------------|-----------------|-------------|---------------------------|-----------------------|-------------|-------------|----------------------|
| <u>COMMUNICATIONS NAVIGATIONAL AIDS AND AIRFIELD LIGHTING</u> | | | | | | | | | |
| <u>Navigation & Traffic Aids Structures:</u> | | | | | | | | | |
| Wind Dir Indicator | 134-678 | | | 1 | 1 | EA | | | |
| <u>OPERATIONAL AND TRAINING FACILITIES</u> | | | | | | | | | |
| <u>Land Operational Facilities:</u> | | | | | | | | | |
| G/M Launch Control | 141-175 | SF | 7,922 | 1 | | | 1 | | |
| Missile Launch Fac | 149-512 | | | 1 | 8 | EA | | | |
| Tunnel | 149-811 | | | 1 | 426 | FT | | | |
| <u>SUPPLY FACILITIES</u> | | | | | | | | | |
| <u>Liquid Fuel Storage:</u> | | | | | | | | | |
| Stor, Diesel | 411-134 | | | 1 | 76 | BL | | | |
| <u>Storage - Covered:</u> | | | | | | | | | |
| Stor Paint & Dope Bse | 442-257 | SF | 225 | 1 | | | 1 | | |
| Shed, Supp & Eqp Base | 442-628 | SF | 24 | 1 | | | 1 | | |
| <u>HOUSING AND COMMUNITY FACILITIES</u> | | | | | | | | | |
| <u>Personnel Support & Service Facilities:</u> | | | | | | | | | |
| SP Con Ident | 730-832 | SF | 187 | 1 | | | 1 | | |

KADENA SITE NR 1 - BASIC DATA

| <u>DESCRIPTION</u> | <u>CATEGORY ITEM NR</u> | <u>UNIT</u> | <u>QUANTITY</u> | <u>CODE</u> | <u>OTHER QUANTITY</u> | <u>OTHER UNIT</u> | <u>PERM</u> | <u>TEMP</u> | <u>SEMI PERM</u> |
|--|-----------------------------|-------------|-----------------|-------------|---------------------------|-----------------------|-------------|-------------|----------------------|
| <u>UTILITIES AND GROUND IMPROVEMENTS</u> | | | | | | | | | |
| <u>Electricity:</u> | | | | | | | | | |
| Primary Dist Line UG | 812-225 | | | 1 | 2,965 | FT | | | |
| Sec Distr Lne UG | 812-226 | | | | 2,500 | FT | | | |
| Security Lights | 812-925 | | | 1 | 17 | EA | | | |
| <u>SEWAGE AND WASTE</u> | | | | | | | | | |
| <u>Sanitary Sewer Facility:</u> | | | | | | | | | |
| Sewage Septic Tank | 831-169 | | | 1 | 1,480 | TD | | | |
| San Sewage Main | 832-266 | | | 1 | 106 | FT | | | |
| <u>Water:</u> | | | | | | | | | |
| Water Supply Treatmt | 841-165 | | | 1 | 10 | TD | | | |
| Water Stor Tank | 841-427 | | | 1 | 30 | TG | | | |
| Water Mains | 842-245 | | | 1 | 4,259 | FT | | | |
| <u>Roads and Streets:</u> | | | | | | | | | |
| Road | 851-147 | SY | 1,958 | 1 | 972 | FT | | | |
| | | | <u>1,540</u> | 3 | <u>1,732</u> | | | | |
| | | | 3,498 | | 2,704 | | | | |

KADENA SITE NR 1 - BASIC DATA

| <u>DESCRIPTION</u> | <u>CATEGORY ITEM NR</u> | <u>UNIT</u> | <u>QUANTITY</u> | <u>CODE</u> | <u>OTHER QUANTITY</u> | <u>OTHER UNIT</u> | <u>PERM</u> | <u>TEMP</u> | <u>SEMI PERM</u> |
|---|-----------------------------|-------------|-----------------|-------------|---------------------------|-----------------------|-------------|-------------|----------------------|
| <u>Ground Improvement Structures:</u> | | | | | | | | | |
| Storm Drnge, Displ | 871-183 | | | 1 | 307 | FT | | | |
| Fence, Security | 872-247 | | | 1 | 2,110 | FT | | | |
| Scty Guard Tower | 872-845 | SF | 121 | | 1 | EA | | | |
| <u>Miscellaneous Utilities:</u> | | | | | | | | | |
| A/C Plt 5 to 25 TN | 890-121 | | | 1 | 10 | TH | | | |
| Load/Unload, Area | 890-152 | SF | 37,860 | 1 | | | | | |
| <u>REAL ESTATE</u> | | | | | | | | | |
| Forgn L/Lse Und 99-Yrs | 922-355 | AC | 52 | | | | | | |
| Improved Grounds | | | 10.30 Acres | | | | | | |
| Unimproved Grounds | | | 41.68 Acres | | | | | | |
| Total | | | 51.98 Acres | | | | | | |
| Total Buildings and Floor Area: 6 Perm 8,647 SF | | | | | | | | | |

Proposed Release of Kadena Site No. 2 (Mace-B)

Attached as inclosure 1 is a multiplex map overlay, scale 1"=400'. Indicated by line thereon is the boundary of subject installation which is located entirely within the boundary of the Army installation known as POL Facilities (White Beach Tank Farm) in the municipality of Katsuren Son. Kadena Site No. 1 is listed in USBRO and occupies 15.18 acres of leased land at an annual rent of \$6,534.25. An indefinite leasehold interest in the 15.18 acres of land is held by the U.S. Government under the terms of the documents listed below.

| <u>Leasehold Document No.</u> | <u>Acres Leased</u> | <u>Annual Rent</u> |
|----------------------------------|---------------------|--------------------|
| Master Lease No. DA92328-ENG-563 | .17 | \$ 41.07 |
| " " " DA92328-ENG-780 | 14.80 | 6,389.14 |
| Declaration of Taking No. 399 | .01 | .84 |
| " " " No. 465 | .20 | 103.20 |
| TOTAL: | 15.18 | \$ 6,534.25 |

No outgranted rights exist for the land, except for the sighting zone which is granted for farming purposes by the U. S. Army under license No. DACA79-3-69-44 issued to Katsuren Son. The sighting zone is leased by the U. S. Government as part of the Army installation known as POL Facilities (White Beach Tank Farm) and it has been used by the U.S. Air Force on an informal basis.

No encroaching structures exist on the leased land comprising subject installation and its access road; however, unauthorized cultivation of sugar cane is being conducted within the sighting zone and a 100' radius from the security fence.

Attached as inclosure 2 is a list of existing buildings and facilities associated thereto within subject installation. Hqs 824th Combat Support Group has advised that the buildings and facilities thereto will be transferred, with the underlying land, on a nonreimbursable basis, to any other interested military service or agency. If the land is to be released to the owners, the Air Force will remove serviceable items worthy of salvage from the buildings.

Upon our receipt of authority to release the land, if no military service or federal agency has a requirement therefor, Notices of Termination will be filed with the Government of the Ryukyu Islands on or before 1 May 1970 to effect release as of 30 June 1970. To avoid payment for a full year's rent for FY-71, Notices of Termination must be filed on or before 30 June 1970. Release of the land will permit unrestricted use by the owners and the U.S. Government will accrue benefits from reduced land rental payments. Rights-of-way for U.S. Forces utility lines and access roads, if any, traversing the area to be released will be retained.

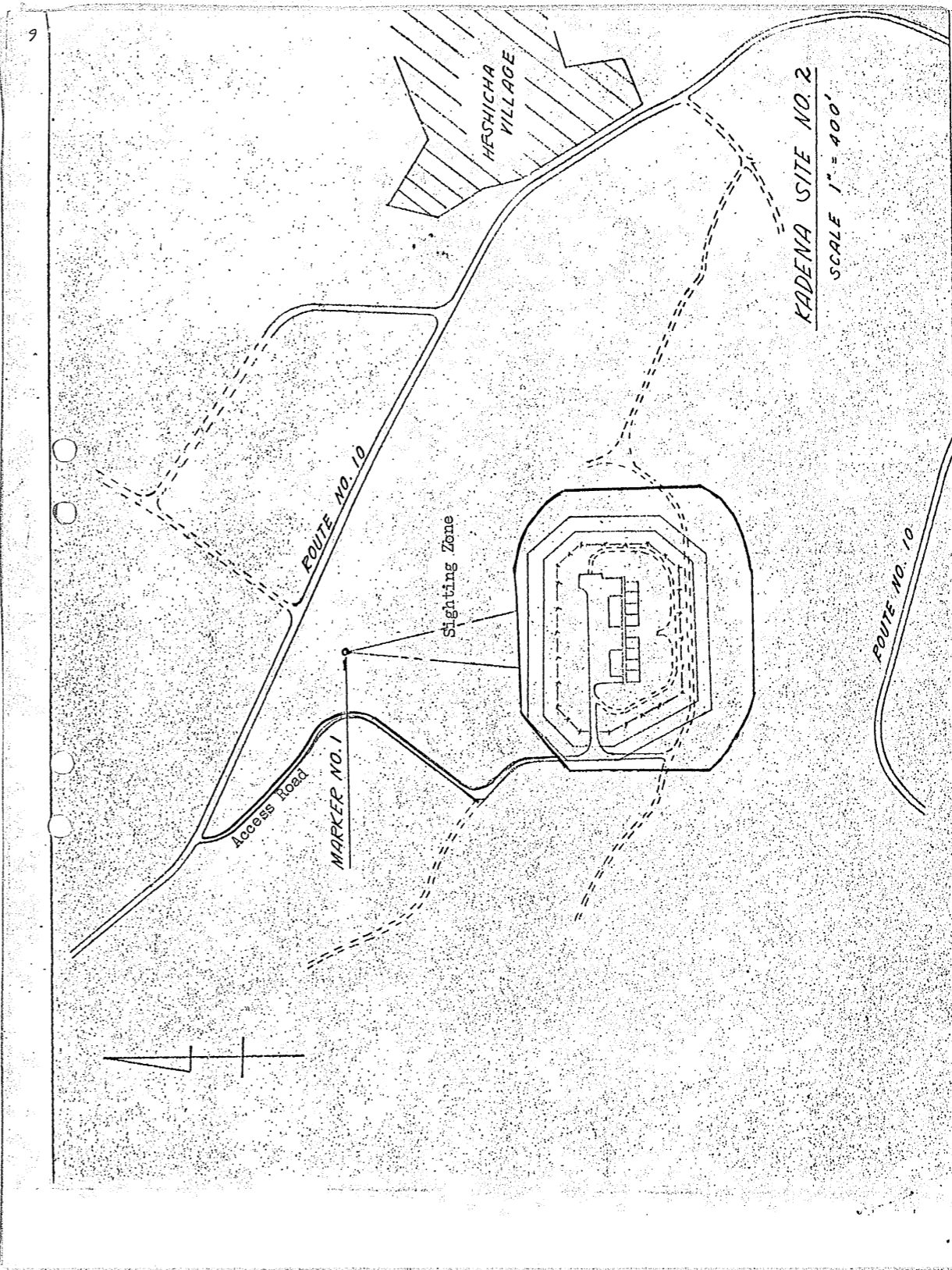

KADENA SITE NR 2

| <u>BLDG #</u> | <u>CAT CODE</u> | <u>NOMENCLATURE</u> | <u>TYPE OF BLDG</u> | <u>DIMENSIONS</u> | <u>SQ FT</u> | <u>OCCUPANT</u> | <u>GRID #</u> | <u>COST CODE</u> |
|---------------|-----------------|------------------------|---------------------|-------------------|--------------|-----------------|------------------|------------------|
| 1 | 730-832 | SE Con Ident | Conc Blk | 11x17 | 187 | 498th TMG | Kadena Site Nr 2 | 57301 |
| 2 | 841-165 | Water, Supply Treatmt | Conc Blk | 14x18 | 252 | 498th TMG | Kadena Site Nr 2 | 58410 |
| 3 | 141-175 | G/M Launch Control | Reinf Conc | 34x233 | 7,922 | 498th TMG | Kadena Site Nr 2 | 51411 |
| 4 | 149-811 | Tunnel | Reinf Conc | 426 FT (Length) | | 498th TMG | Kadena Site Nr 2 | 51505 |
| 5 | 149-512 | Missile Launch Fac | Reinf Conc | EA 8 | | 498th TMG | Kadena Site Nr 2 | 51505 |
| 6 | 442-628 | Shed, Sup & Eqp Base | Conc Blk | 4x6 | 24 | 498th TMG | Kadena Site Nr 2 | 54401 |
| 7 | 442-257 | Stor, Paint & Dope Bse | Conc Blk | 15x15 | 225 | 498th TMG | Kadena Site Nr 2 | 54401 |

Handwritten mark

KADENA SITE NR 2 - BASIC DATA

| <u>DESCRIPTION</u> | <u>CATEGORY ITEM NR</u> | <u>UNIT</u> | <u>QUANTITY</u> | <u>CODE</u> | <u>OTHER QUANTITY</u> | <u>OTHER UNIT</u> | <u>PERM</u> | <u>TEMP</u> | <u>SEMI PERM</u> |
|---|-----------------------------|-------------|-----------------|-------------|---------------------------|-----------------------|-------------|-------------|----------------------|
| <u>COMMUNICATIONS NAVIGATIONAL AIDS AND AIRFIELD LIGHTING</u> | | | | | | | | | |
| <u>Navigation & Traffic Aids Structures:</u> | | | | | | | | | |
| Wind Dir Indicator | 134-678 | | | 1 | 1 | EA | | | |
| <u>OPERATIONAL AND TRAINING FACILITIES</u> | | | | | | | | | |
| <u>Land Operational Facilities:</u> | | | | | | | | | |
| G/M Launch Control | 141-175 | SF | 7,922 | 1 | | | 1 | | |
| Missile Launch Fac | 149-512 | | | 1 | 8 | EA | | | |
| Tunnel | 149-811 | | | 1 | 426 | FT | | | |
| <u>SUPPLY FACILITIES</u> | | | | | | | | | |
| <u>Liquid Fuel Storage:</u> | | | | | | | | | |
| Stor, Diesel | 411-134 | | | 1 | 76 | BL | | | |
| <u>Storage - Covered:</u> | | | | | | | | | |
| Stor Paint & Dope Bse | 442-257 | SF | 225 | 1 | | | 1 | | |
| Shed, Sup & Eqp Bse | 442-628 | SF | 24 | 1 | | | 1 | | |
| <u>HOUSING AND COMMUNITY FACILITIES</u> | | | | | | | | | |
| <u>Personnel Support & Service Facilities:</u> | | | | | | | | | |
| SP Con Ident | 730-832 | SF | 187 | 1 | | | 1 | | |

KADENA SITE NR 2 - BASIC DATA

| <u>DESCRIPTION</u> | <u>CATEGORY ITEM NR</u> | <u>UNIT</u> | <u>QUANTITY</u> | <u>CODE</u> | <u>OTHER QUANTITY</u> | <u>OTHER UNIT</u> | <u>PERM</u> | <u>TEMP</u> | <u>SEMI PERM</u> |
|--|-----------------------------|-------------|-----------------|-------------|---------------------------|-----------------------|-------------|-------------|----------------------|
| <u>UTILITIES AND GROUND IMPROVEMENTS</u> | | | | | | | | | |
| <u>Electricity:</u> | | | | | | | | | |
| Primary Dist Line UG | 812-225 | | | 1 | 2,665 | FT | | | |
| Flood Light | 812-923 | | | 1 | 1 | EA | | | |
| Security Lights | 812-925 | | | 1 | 17 | EA | | | |
| <u>SEWAGE AND WASTE:</u> | | | | | | | | | |
| <u>Sanitary Sewer Facility:</u> | | | | | | | | | |
| Sewage Septic Tank | 831-169 | | | 1 | 1,480 | TD | | | |
| San Sewage Main | 832-266 | | | 1 | 83 | FT | | | |
| <u>Water:</u> | | | | | | | | | |
| Water, Supply Treatmt | 841-165 | | | 1 | 10 | TD | | | |
| Water Mains | 842-245 | | | 1 | 670 | FT | | | |
| <u>Roads and Streets:</u> | | | | | | | | | |
| Road | 851-147 | SY | 3,511 | 1 | 1,755 | FT | | | |
| | | | <u>1,897</u> | 3 | <u>1,281</u> | FT | | | |
| | | | 5,408 | | 3,036 | | | | |
| Park, Vehicle, Non-Org | 852-262 | SY | 161 | 1 | | | | | |

KADENA SITE NR 2 - BASIC DATA

| <u>DESCRIPTION</u> | <u>CATEGORY</u> <u>ITEM NR</u> | <u>UNIT</u> | <u>QUANTITY</u> | <u>CODE</u> | <u>OTHER</u> <u>QUANTITY</u> | <u>OTHER</u> <u>UNIT</u> | <u>PERM</u> | <u>TEMP</u> | <u>SEMI</u> <u>PERM</u> |
|---|-----------------------------------|-------------|-----------------|-------------|---------------------------------|-----------------------------|-------------|-------------|----------------------------|
| <u>Ground Improvement Structures:</u> | | | | | | | | | |
| Storm Drnge, Displ | 871-183 | | | 1 | 530 | FT | | | |
| Fence, Security | 872-247 | | | 1 | 2,061 | FT | | | |
| <u>Miscellaneous Utilities:</u> | | | | | | | | | |
| A/C Plt 5 to 25 TN | 890-121 | | | 1 | 10 | TN | | | |
| Load/Unload, Area | 890-152 | SF | 35,800 | 1 | | | | | |
| <u>REAL ESTATE</u> | | | | | | | | | |
| Forgn L/Lse Und 99-Yrs | 922-355 | AC | 15 | | | | | | |
| Improved Grounds | | | 5.80 Acres | | | | | | |
| Unimproved Grounds | | | 9.38 Acres | | | | | | |
| Total | | | 15.18 Acres | | | | | | |
| Total Buildings and Floor Area: 5 Perm 8,610 SF | | | | | | | | | |

Proposed Release of Kadena Site No. 4 (Mace-B)

Attached as inclosure 1 is a multiplex map overlay, scale 1"=400'. Indicated by line thereon is the boundary of subject installation which is located within the municipality of Onna Son. Kadena Site No. 4 is listed in USBRO and occupies 19.96 acres of leased land at an annual rent of \$835.14. An indefinite leasehold interest in the 19.96 acres of land is held by the U.S. Government under the terms of the documents listed below. The access road from Route No. 1 to the site is leased as part of the U.S. Army installation known as Onna Point Army Annex, (Nike Site 2-B).

| <u>Leasehold Document No.</u> | <u>Acres Leased</u> | <u>Annual Rent</u> |
|----------------------------------|---------------------|--------------------|
| Master Lease No. DA92328-ENG-571 | 2.82 | \$ 121.80 |
| " " " DA92328-ENG-765 | 7.51 | 238.97 |
| " " " DA92328-ENG-490 | 8.30 | 382.34 |
| Declaration of Taking No. 426 | 1.33 | 92.03 |
| TOTAL: | 19.96 | \$ 835.14 |

Approximately 12.50 acres of the leased land outside the security fence are granted for farming purposes under license No. DACA79-3-70-36 issued to the municipality of Onna Son which expires on 14 November 1974. No encroaching structures exist within the installation.

Attached as inclosure 2 is a list of existing buildings and facilities associated thereto within subject installation. Hqs 824th Combat Support Group has advised that the buildings and facilities thereto will be transferred, with the underlying land, on a nonreimbursable basis, to any other interested military service or agency. If the land is to be released to the owners, the Air Force will remove serviceable items worthy of salvage from the buildings.

Upon our receipt of authority to release the land, if no military service or federal agency has a requirement therefor, Notices of Termination will be filed with the Government of the Ryukyu Islands on or before 1 May 1970 to effect release as of 30 June 1970. To avoid payment for a full year's rent for FY-71, Notice of Termination must be filed on or before 30 June 1970. Release of the land will permit unrestricted use by the owners and the U.S. Government will accrue benefits from reduced land rental payments. Rights-of-way for U.S. Forces utility lines and access roads, if any, traversing the area to be released will be retained.

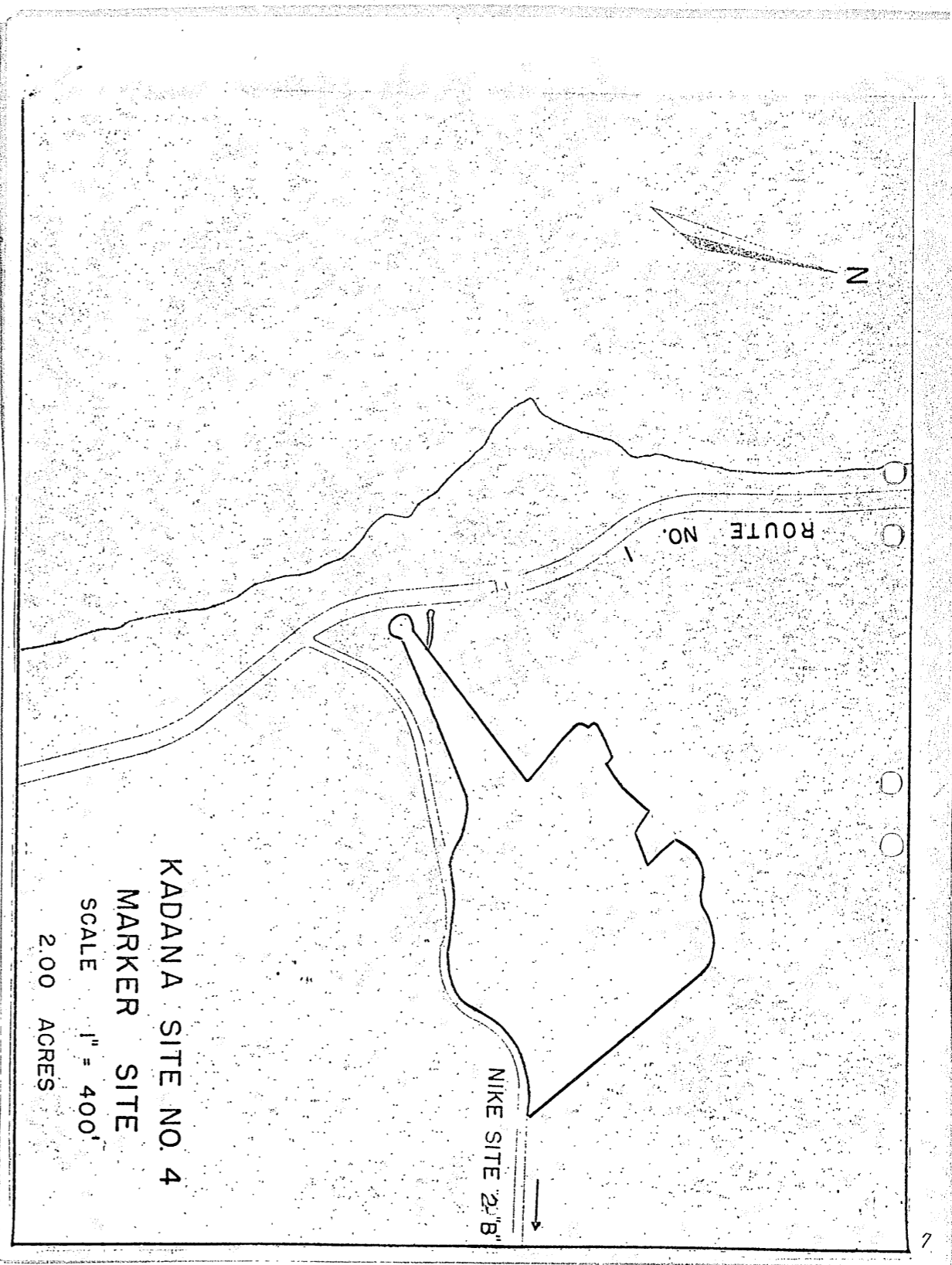

KADENA SITE NR 4

| <u>BLDG #</u> | <u>CAT CODE</u> | <u>NOMENCLATURE</u> | <u>TYPE OF BLDG</u> | <u>DIMENSIONS</u> | <u>SQ FT</u> | <u>OCCUPANT</u> | <u>GRID #</u> | <u>COST CODE</u> |
|---------------|-----------------|-----------------------|---------------------|-------------------|--------------|-----------------|------------------|------------------|
| 1 | 730-832 | SP Con Ident | Reinf Conc | 11x17 | 187 | 498 TMG | Kadena Site Nr 4 | 57301 |
| 2 | 441-254 | Stor, Gases Bottled | Reinf Conc | 16x19 | 304 | 498 TMG | Kadena Site Nr 4 | 54401 |
| 3 | 141-175 | G/M Launch Control | Reinf Conc | 34x112, 34x72 | 6,256 | 498 TMG | Kadena Site Nr 4 | 51411 |
| 4 | 149-811 | Tunnel | Reinf Conc | 353 FT (Length) | | 498 TMG | Kadena Site Nr 4 | 51505 |
| 5 | 149-512 | Missile Launch Fac | Reinf Conc | EA 8 | | 498-TMG | Kadena Site Nr 4 | 51505 |
| 6 | 442-628 | Shed, Sup & Eqp Base | Conc Blk | 4x6 | 24 | 498 TMG | Kadena Site Nr 4 | 54401 |
| 7 | 442-257 | Stor Paint & Dope Bse | Conc Blk | 15x15 | 225 | 498 TMG | Kadena Site Nr 4 | 54401 |

Sub 2

KADENA SITE NR 4 - BASIC DATA

| <u>DESCRIPTION</u> | <u>CATEGORY ITEM NR</u> | <u>UNIT</u> | <u>QUANTITY</u> | <u>CODE</u> | <u>OTHER QUANTITY</u> | <u>OTHER UNIT</u> | <u>PERM</u> | <u>TEMP</u> | <u>SEMI PERM</u> |
|---|-----------------------------|-------------|-----------------|-------------|---------------------------|-----------------------|-------------|-------------|----------------------|
| <u>COMMUNICATIONS NAVIGATIONAL AIDS AND AIRFIELD LIGHTING</u> | | | | | | | | | |
| <u>Navigation & Traffic Aids Structures:</u> | | | | | | | | | |
| Wind Dir Indicator | 134-678 | | | 1 | 1 | EA | | | |
| <u>OPERATIONAL AND TRAINING FACILITIES</u> | | | | | | | | | |
| <u>Land Operational Facilities:</u> | | | | | | | | | |
| G/M Launch Control | 141-175 | SF | 6,256 | 1 | | | .1 | | |
| Missile Launch Fac | 149-512 | | | 1 | 8 | EA | | | |
| Tunnel | 149-811 | | | 1 | 353 | FT | | | |
| <u>SUPPLY FACILITIES</u> | | | | | | | | | |
| <u>Liquid Fuel Storage:</u> | | | | | | | | | |
| Stor, Diesel | 411-134 | | | 1 | 57 | BL | | | |
| <u>Hazardous and Flammable Storage:</u> | | | | | | | | | |
| Stor, Gases, Bottled | 441-254 | SF | 304 | 1 | | | 1 | | |
| <u>Storage - Covered:</u> | | | | | | | | | |
| Stor, Paint & Dope Bse | 442-257 | SF | 225 | 1 | | | 1 | | |
| Shed, Sup & Eqp Base | 442-628 | SF | 24 | 1 | | | 1 | | |

KADENA SITE NR 4 - BASIC DATA

| <u>DESCRIPTION</u> | <u>CATEGORY ITEM NR</u> | <u>UNIT</u> | <u>QUANTITY</u> | <u>CODE</u> | <u>OTHER QUANTITY</u> | <u>OTHER UNIT</u> | <u>PERM</u> | <u>TEMP</u> | <u>SEMI PERM</u> |
|--|-----------------------------|-------------|-----------------|-------------|---------------------------|-----------------------|-------------|-------------|----------------------|
| <u>HOUSING AND COMMUNITY FACILITIES</u> | | | | | | | | | |
| <u>Personnel Support and Service Facilities:</u> | | | | | | | | | |
| SP Con Ident | 730-832 | SF | 187 | 1 | | | 1 | | |
| <u>UTILITIES AND GROUND IMPROVEMENTS</u> | | | | | | | | | |
| <u>Electricity:</u> | | | | | | | | | |
| Second Dist Line UG | 812-226 | | | 1 | 2,774 | FT | | | |
| Security Lights | 812-925 | | | 1 | 19 | EA | | | |
| <u>SEWAGE AND WASTE</u> | | | | | | | | | |
| <u>Sanitary Sewer Facility:</u> | | | | | | | | | |
| Sewage Septic Tank | 831-169 | | | 1 | 1,000 | TD | | | |
| San Sewage Main | 832-266 | | | 1 | 235 | FT | | | |
| <u>Water:</u> | | | | | | | | | |
| Water Stor Tank | 841-427 | | | 1 | 11 | TG | | | |
| Water Mains | 842-245 | | | 1 | 9,047 | FT | | | |
| <u>Roads and Streets:</u> | | | | | | | | | |
| Road | 851-147 | SY | 2,075 | 1 | 805 | FT | | | |
| | | | 217 | 3 | 325 | | | | |
| | | | <u>2,292</u> | | <u>1,130</u> | | | | |

KADENA SITE NR 4 - BASIC DATA

| <u>DESCRIPTION</u> | <u>CATEGORY ITEM NR</u> | <u>UNIT</u> | <u>QUANTITY</u> | <u>CODE</u> | <u>OTHER QUANTITY</u> | <u>OTHER UNIT</u> | <u>PERM</u> | <u>TEMP</u> | <u>SEMI PERM</u> |
|---|-----------------------------|-------------|-----------------|-------------|---------------------------|-----------------------|-------------|-------------|----------------------|
| <u>Roads and Streets (Cont'd)</u> | | | | | | | | | |
| Park, Vehicle, Non-Org | 852-262 | SY | 432 | 1 | | | | | |
| <u>Ground Improvement Structures:</u> | | | | | | | | | |
| Storm Dmge, Displ | 871-183 | | | 1 | 2,261 | FT | | | |
| Fence, Security | 872-247 | | | 1 | 2,225 | FT | | | |
| <u>Miscellaneous Utilities:</u> | | | | | | | | | |
| A/C Plt 5 to 25 TN | 890-121 | | | 1 | 10 | IN | | | |
| Load/Unload, Area | 890-152 | SF | 32,064 | 1 | | | | | |
| <u>REAL ESTATE</u> | | | | | | | | | |
| Forgn L/Lse Und 99-Yrs | 922-355 | AC | 20 | | | | | | |
| Improved Grounds | | | 8.70 Acres | | | | | | |
| Unimproved Grounds | | | 11.26 Acres | | | | | | |
| Total | | | 19.96 Acres | | | | | | |
| Total Buildings and Floor Area: 5 Perm 6,996 SF | | | | | | | | | |

Proposed Release 6.62 Acre Portion of Yoza Dake Air Station

Yoza Dake Air Station is located approximately 6 miles southeast of Naha Air Base. The installation comprises a total of 72.10 acres of land, of which 60.76 acres are leased under Master Lease No. DA92328-ENG-223 at an annual rent of \$4,538.02 and 11.30 acres are leased under Declaration of Taking No. 251 at an annual rent of \$889.21, both for an indefinite period. The remaining .04 acre is Japanese Government-owned land held by the U.S. Government under Allocation No. US-336, free of rent.

The annual rent for the 6.62 acres of land proposed for release or transfer is estimated to be \$500.00. This land is comprised of three separate areas outside the security fence of the installation which were previously utilized as a communications facility by the U.S. Navy under the terms of a real estate permit. There are no U.S. Government-owned improvements on the land and no rights in the land are outgranted. The boundary of the entire installation is shown on the attached overlay of multiplex map sheet No. 199, scale 1"=400', with the areas proposed for release shown in hachures. Rental for the land has been paid through 30 June 1970.

